

BGSU's Macintosh OS 9 Wireless Client Setup and Authentication Quick Reference

What you need:

- 802.11b compatible wireless ethernet card installed
- Laptop computer running Mac OS 9.x

1. Click on the **Apple** pull-down menu and select **Airport**.
2. Click on the **Settings** arrow to expand its menu.
3. Check **“Allow section of closed networks.”**
4. Click the **“Choose Network”** pull-down menu and select **“Other”**.
5. Type **“bgsu”** (lower case without the quotation marks) in the space where it says **“Name”** and click **OK**.

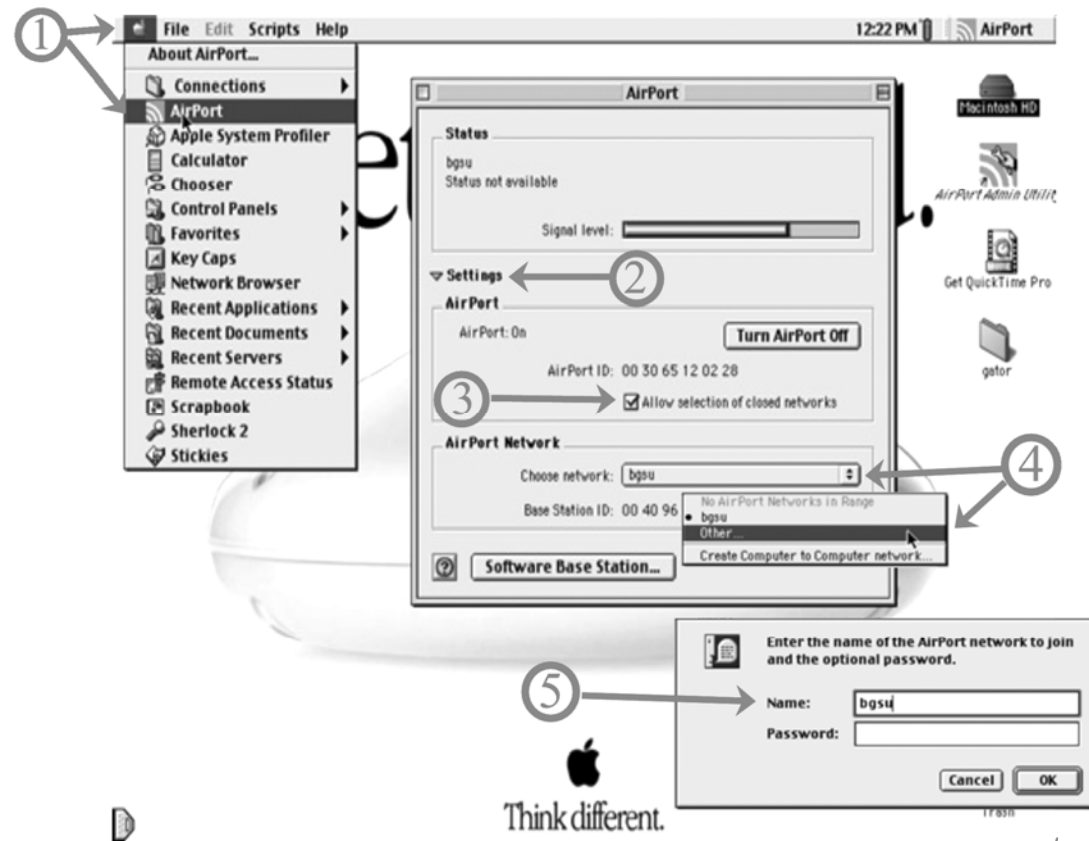

To use BGSU's Bluesocket Wireless Gateway means that every time you want to gain access to BGSU's wireless network, you will need to open up a web browser which will automatically display an authentication page. After successfully entering your BGSU username and password, you will receive full network access. Then you will be allowed to access the network for up to 12 hours without having to re-authenticate. However, if you disappear off the network for more than 10 minutes by wandering out of range of the wireless coverage area or by inactivity (e.g. your laptop or hand-held device goes into power save), you will have to re-authenticate. BGSU's Bluesocket wireless gateway is another layer of protection for you and your data.

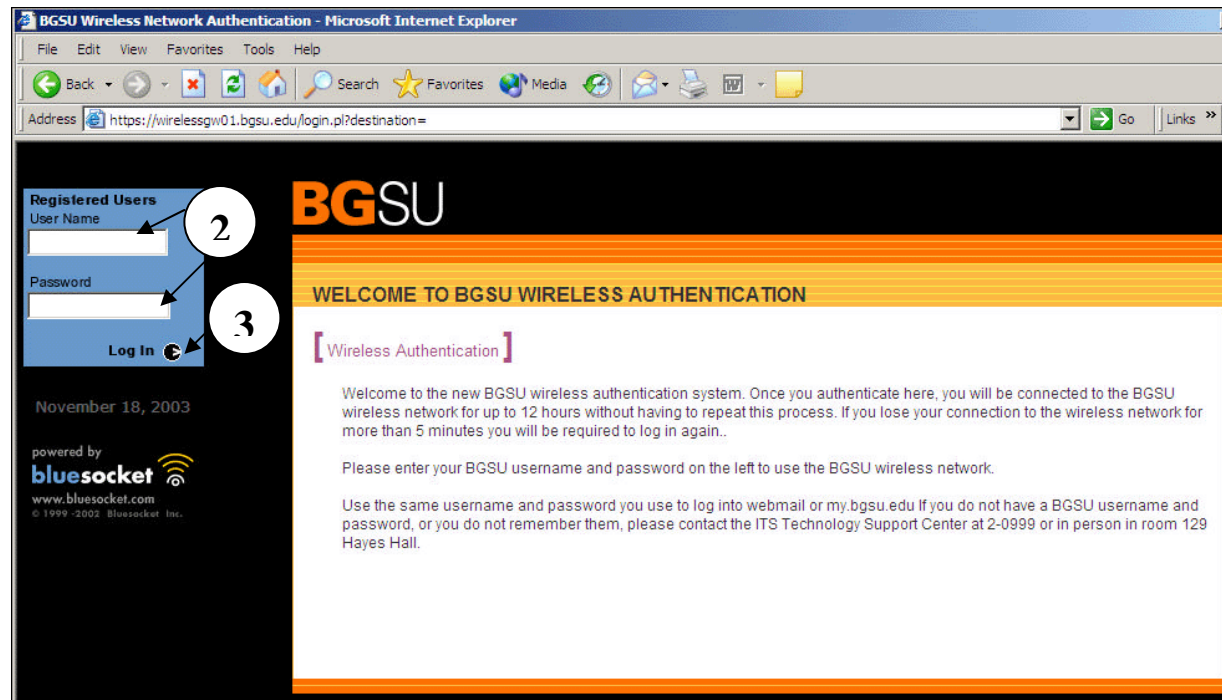

1. Open a web browser and you will be automatically directed to the BlueSocket authentication page.
2. In the User Name/Password fields in the upper left corner of the page, enter your BGNet user name and password (i.e. BGSU email credentials).
3. Click Login.

Upon successful login, your username and assigned IP address are displayed. In 5 seconds you are automatically redirected to the BGSU homepage. If not, click "continue searching the web". Enjoy!

If you have not established an account, or you are having technical difficulty, please contact the ITS Technology Support Center at 2-0999 or in person in room 110 Hayes Hall.

For more information about Wireless Connections at BGSU, see <http://www.bgsu.edu/its/network/>